

Hiron

Instruction Manual

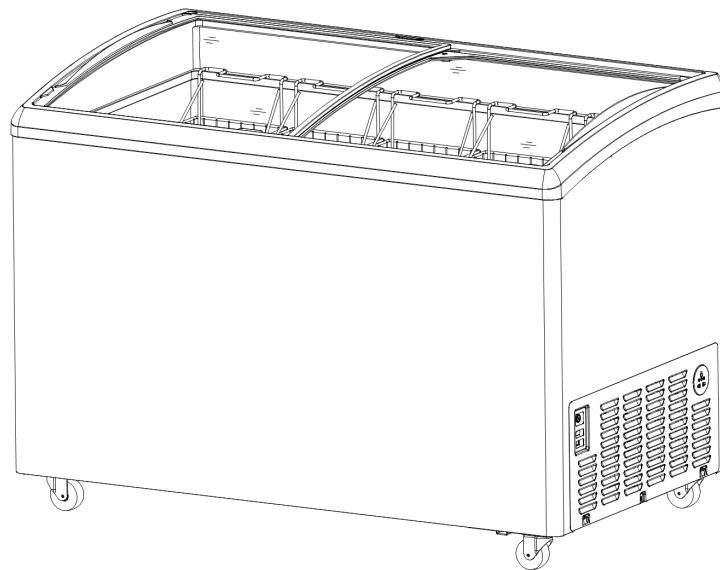

Read the instruction manual before power on for the first time as it contains important information on its safety and proper use, installation and care. Please keep the instruction manual in a safe place for future reference. Moreover, please pass it on to possible new owners of this appliance.

【Original instructions】

CONTENTS

<u>CONTENTS</u>	2
<u>STANDARDS</u>	3-4
<u>PARTS & FEATURES</u>	5
<u>APPLIANCE SAFETY</u>	6-9
<u>FLAMMABLE REFRIGERANT WARNINGS</u>	10
<u>TRANSPORTATION AND INSTALLATION INSTRUCTIONS</u>	11
<u>OPERATING YOUR APPLIANCE</u>	12-13
<u>CARE AND MAINTENANCE</u>	14-16
<u>MANUFACTURER OR IMPORTER INFORMATION</u>	16

STANDARDS

Safety

This appliance is to be safe to transport, store, operate, maintain and dispose of. They are to meet all relevant and compulsory safety standards in force at the market they are intended e.g.

Europe EN 60335 - 1, EN 60335 - 2 - 89

IEC countries IEC 60335 - 1, IEC 60335 - 2 - 89

RoHs / WEEE

This appliance meets RoHs and WEEE directives.

Climate rating acc to IEC/EN 60335 - 2 - 89

The climate class alpha-numeric characters mean the test room climate class of the appliance.

Climate rating	Test room temperature
0,1,2,3,4,6,8	32°C ± 2°C
5,7	43°C ± 2°C

The climate rating is indicated on the type plate.

FOR THE ICE-CREAM FREEZERS:

Climate class acc to EN 16901

Test room Climate class	Min temperature and relative humidity	Max temperature and relative humidity
A	16°C/80%	30°C/55%
B	16°C/80%	35°C/75%
C	16°C/80%	40°C/40%

The climate class is indicated on the type plate.

This appliance is intended to operate in climates where the temperature and the humidity range from 16°C/80%RH to 35°C /75%RH(climate class B).

Temperature class acc to EN 16901

Class	Warmest M-package temperature colder or equal to	Warmest M-package maximum temperature rise allowed/K
C1	-18	2
C2	-7	2

The temperature class is indicated on the type plate.

FOR THE SUPERMARKET CABINETS:

Climate class acc to EN/ISO 23953-2

Test room Climate class	Dry bulb temperature/°C	Relative humidity/%
0	20	50
1	16	80
8	24	55
2	22	65
3	25	60
4	30	55
6	27	70
5	40	40
7	35	75

The climate class is indicated on the type plate.

Temperature class acc to EN/ISO 23953-2

Class	Highest temperature-of warmest M-Test gelato tubs/°C	Highest minimum temperature of all Test tubs/°C
L1	-15	-18
L2	-12	-18
L3	-12	-15

The temperature class is indicated on the type plate.

REMARK: The supermarket cabinets can also be used to store and display packaged ice cream and other frozen desserts.

FOR THE SCOOPING CABINETS:

Climate class acc to EN 16838

Test room Climate class	Dry bulb temperature/°C	Relative humidity/%
0	20	50
1	16	80
8	24	55
2	22	65
3	25	60
4	30	55
6	27	70
5	40	40
7	35	75

The climate class is indicated on the type plate.

Temperature class acc to EN 16838

Class	Highest temperature-of warmest M-Test gelato tubs/°C	Highest minimum temperature of all Test tubs/°C
L1	-15	-18
L2	-12	-18
L3	-12	-15

The temperature class is indicated on the type plate.

PARTS & FEATURES

ICE-CREAM FREEZERS:

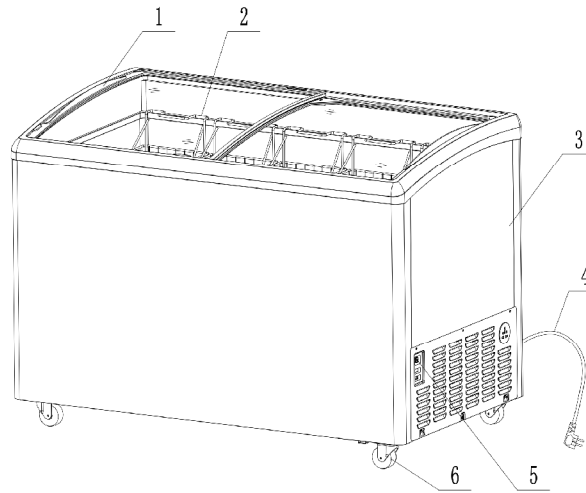

- 1. Glass doors;2. Baskets;3. Body;4. Power cord;5. Control panel;6. Castors**

SUPERMARKET CABINETS:

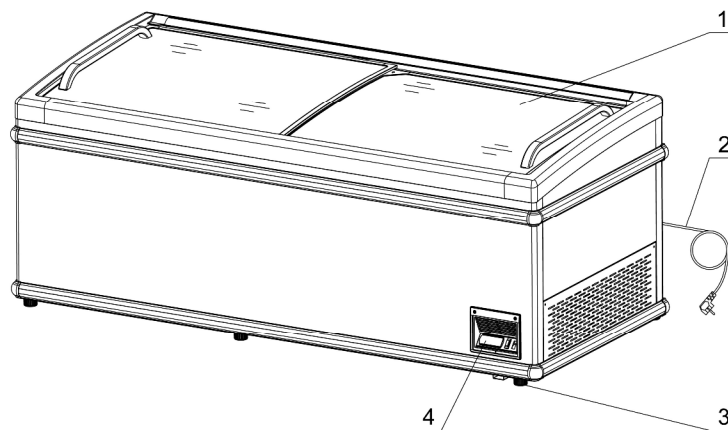

- 1. Glass doors;2. Power cord;3. Foot bolts (or Castors);4. Control panel**

SCOOPING CABINETS:

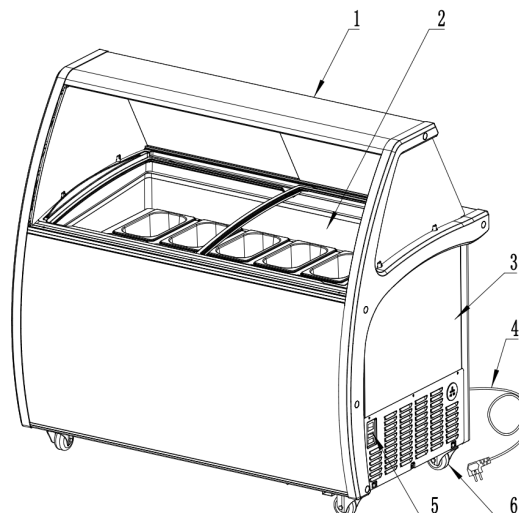

- 1. Canopy;2. Glass doors;3. Body;4. Power cord;5. Control panel;6. Castors**

APPLIANCE SAFETY

Your safety and the safety of others are very important.

We have provided many important safety messages in this manual and on your appliance. Always read and obey all safety messages.



This is the Safety Alert Symbol. This symbol alerts you to potential hazards that can kill or injure you and others. All safety messages will follow the Safety Alert Symbol and either the words “DANGER” , “WARNING” or “CAUTION” .



Danger means that failure to heed this safety statement may result in severe personal injury or death.



Warning means that failure to heed this safety statement may result in extensive product damage, serious personal injury, or death.



Caution means that failure to heed this safety statement may result in minor or moderate personal injury, or property or equipment damage.

All safety messages will alert you to what the potential hazard is, tell you how to reduce the chance of injury, and let you know what will happen if the instructions are not followed.

IMPORTANT SAFEGUARDS



Before using the appliance, it must be properly positioned and installed as described in this manual, so read the manual carefully. To reduce the risk of fire, electrical shock, or injury while using the appliance, follow basic precautions, including the following:



- This appliance is not intended for use by persons (including children) with reduced physical, sensory or mental capabilities, or lack of experience and knowledge unless they have been given supervision or instruction concerning use of the appliance by a person responsible for their safety.
- Children should be supervised to ensure that they do not play with the appliance.
- This appliance can be used by children aged from 8 years and above and persons with reduced physical sensory or mental capabilities or lack of experience and knowledge if they have been given supervision or instruction concerning use of the appliance in a safe way and understand the hazards involved.
- Children shall not play with the appliance.
- Cleaning and user maintenance shall not be made by children without supervision.
- DO NOT allow children to play with the packaging, and destroy plastic bags safely.
- **DANGER or WARNING:** Risk of child entrapment: Child entrapment and suffocation are not problems of the past. Junked or abandoned freezers are still dangerous, even if they will “just sit in the garage a few days.”
- **Before you throw away your old freezer:** Take off the doors. Leave the shelves in place so that children may not easily climb inside.
- Please according to local regulation disposal of the appliance for its flammable refrigerant and blowing gas.
- This appliance must be connected with the earth correctly, never with the heating pipe and coal gas pipe.
- This appliance shall be positioned so that the plug is accessible.
- If the power cord is damaged, it must be replaced by the manufacturer, its service agent, or similarly qualified persons in order to avoid a hazard.
- Do not attempt to repair or replace any part of your appliance unless it is specifically recommended in this material. All other servicing should be referred to a qualified technician.



Do not attempt to repair the hermetic refrigeration system!
Ne tentez pas la réparation du système de réfrigération hermétique!
Versuchen Sie nicht das hermetische Kühlsystem zu reparieren!
No intente reparar el sistema de refrigeracion hermético!

! WARNING !

- This appliance should not be located next to ovens, grills, or other sources of high heat.
- Keep clear of obstruction all ventilation openings, in the appliance enclosure or the structure for built-in.
- Do not store explosive substances such as aerosol cans with a flammable propellant in this appliance.
- Do not use mechanical devices or other means to accelerate the defrosting process, other than those recommended by the manufacturer.
- Do not damage the refrigerant circuit.
- Do not use electrical appliances inside the food storage compartments of the appliance, unless they are recommended by the manufacturer.

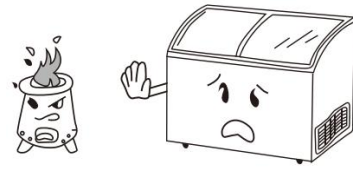

- Before proceeding with cleaning and maintenance operations, make sure the power line of the unit is disconnected.
- Do not connect or disconnect the electric plug when your hands are wet.

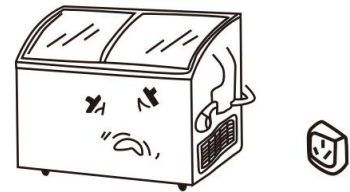

- Do not store or use gasoline or any other flammable vapors and liquids in the vicinity of this or any other freezer. Never clean freezer parts with flammable fluids. The fumes can create a fire hazard or explosion.

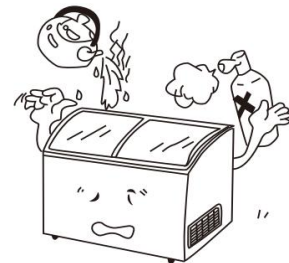

- The power supply is AC220-240V/50Hz, If the voltage is unstable, please choose the suitable automatic voltage regulator.
- Connection the power to check the freezer before using, the freezer can be used until the temperature decreases obviously after 30 minutes.
- You should adjust the temperature control according to the requested temperature and quantity of the stored ice cream and the environmental temperature.
- Before putting the ice cream into the freezer, please adjust the temperature control to the lowest point and let it work till the temperature of the inner cabinet decreases to -18°C and then putting the ice cream in, after 12 hours adjust the temperature control to the normal point.



- Never put hot food in the freezer.
- The ice cream should be put into the freezer partially, each lot will not be more than the figure which is equal to the capacity(L) divide by 20.
- DO NOT full the freezer and make it crowded, There should be reasonable space between the ice cream for better freezing.
- If the power cut off is needed, you should wait for at least 5 minutes before turn on again to avoid damage to the compressor.
- The ice cream stored should be packed with plastic bag well to avoid smell-mixed and moisture-lost, and reduce the frost at the small time.
- Beer, beverage, fresh flower, medicine, and injections can not be put into the freezer.
- Please make the temperature control to the lowest point if you want to store ice cream.
- Do not use extension cords.
- The power cord should not be removed or altered in any way.
- DO NOT use jet/pressure washers to clean the freezer.
- We have a policy of continuous improvement on our products and reserve the right to change materials and specifications without notice. To confirm the specific parameters, please according to the rated label on the product.
- Shall, when the product scrap/recovered by professional scrap/recycling locations to deal with.

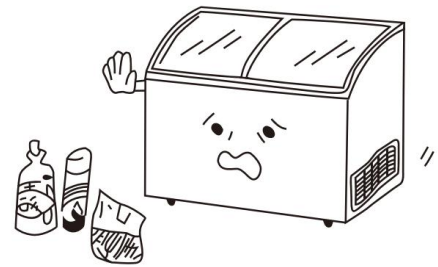

FLAMMABLE REFRIGERANT WARNINGS



CAUTION FLAMMABLE REFRIGERANT

- I **DANGER** – Risk Of Fire Or Explosion. Flammable Refrigerant Used. To Be Repaired Only By Trained Service Personnel. Do Not Puncture Refrigerant Tubing.
- I **WARNING** – Keep clear of obstruction all ventilation openings in the appliance enclosure or the structure for building-in.
- I **WARNING** – Do not use mechanical devices or other means to accelerate the defrosting process, other than those recommended by the manufacturer.
- I **WARNING** – Do not use electrical appliances inside the food storage compartments of the appliance, unless they are of the type recommended by the manufacturer..
- I **CAUTION** – Risk Of Fire Or Explosion. Flammable Refrigerant Used. Consult Repair Manual/Owner’s Guide Before Attempting To Install or Service This Product. All Safety Precautions Must be Followed
- I **CAUTION** – Risk Of Fire Or Explosion.Flammable Refrigerant Used.Dispose Of Properly In Accordance With Local Regulations.
- I **CAUTION** – Risk Of Fire Or Explosion Due To Puncture Of Refrigerant Tubing,Follow Handling Instructions Carefully. Flammable Refrigerant Used.

TRANSPORTATION AND INSTALLATION INSTRUCTIONS

TRANSPORTATION:

1. When you transport the appliance, the angle between the compartment body and the ground should be no more than 45° and you should never place the appliance up-side-down.
2. Do not use any of the external parts as loading points, for example, the condenser on the back, the door.

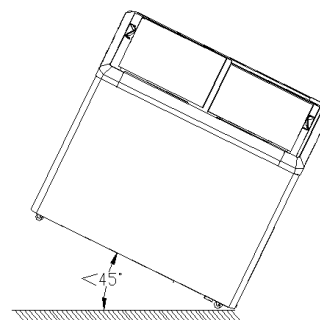

INSTALLATION:

1. When the appliance is installed or used, all the package (including board and foam plastic) should be got rid of.
2. The minimum room temperature at the place of installation is 10°C.
3. Keeping the appliance stable to avoid vibration and noise.

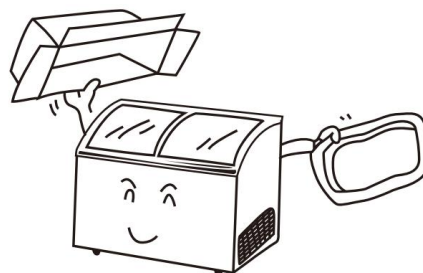

4. The appliance should be installed in a place with good ventilation, a space of at least 10cm should be allowed between the surrounding walls and the cabinet wall for air condition.

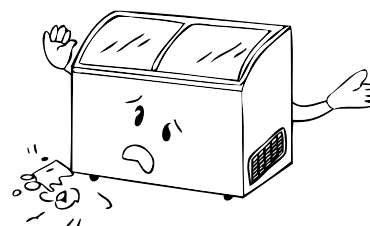

5. The appliance should be placed far from the heating resource and not under direct sunshine to avoid a decrease in the efficiency of refrigeration.

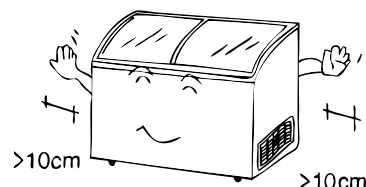

6. Install the appliance in a dry place to prevent rust on the compartment body, which may affect the electric insulation.

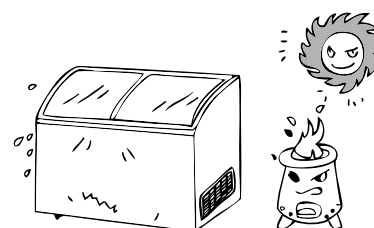

- I **WARNING:** When positioning the appliance ensure the supply cord is not trapped or damaged.
- I **WARNING:** Do not locate multiple portable socket-outlets or portable power supplies at the rear of the appliance.



OPERATING YOUR APPLIANCE

POWER SUPPLY

The power supply should always be in accordance with the rating plate on the back of the appliance ; here you can read the voltage (V) and frequency (Hz) . The power supply must always be in accordance with the law and regulation of the country with regard to electrical safety . If you are in doubt ask your supplier .

STARTING UP

If the compressor does not start when the appliance has been plugged in , then the power supply of the unit is not in order . Check if there is electricity running from the power socket to the plug or if the fuse is blown.

THE FUNCTION OF CONTROL PANEL:

MECHANICAL THERMOSTAT:

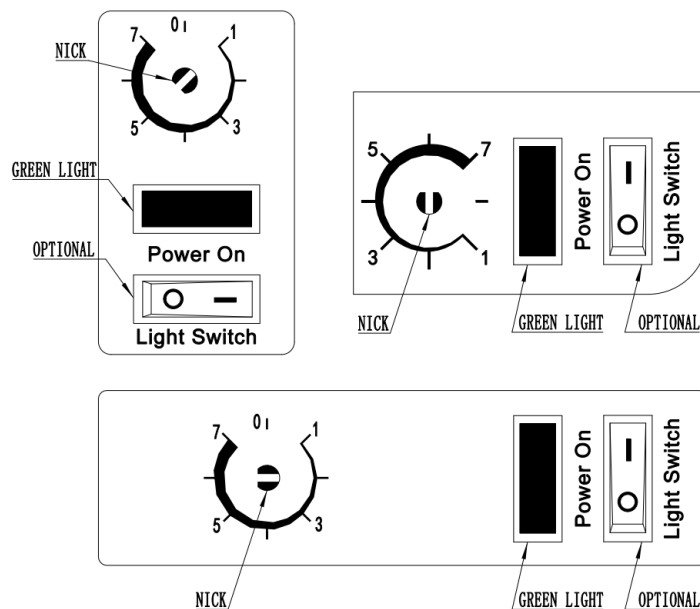

1. The figure on the temperature control 1~7 only means the temperature level from high to low, not means the specific temperature.
2. The green light is a power indicator, when it is on , the power is connected.
3. We need to use a special tool (for example, a flat-blade screwdriver) to turn the knob till the nick pointing to a specific figure (1~7).
4. Turn the knob clockwise, the temperature inside will go down, turn the knob in the other direction, the temperature will go up.
5. When you turn the knob anticlockwise to "0", the compressor will stop working.
6. We recommend the nick pointing to the 6 or 5, to ensure the ice cream inside the cabinet is frozen effectively.

DANGER

Do not turn the knob from "7" to "0" or "0" to "7" !

ELECTRONIC THERMOSTAT:

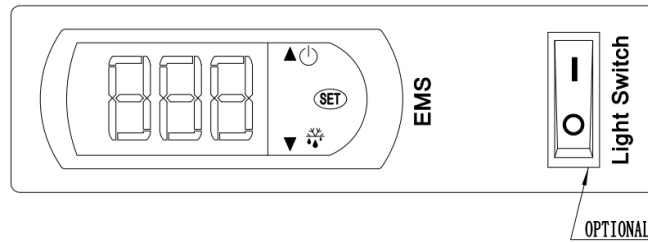

1. The EMS is electronic controller.
2. The electronic controller has been already set in the factory.
3. If you need to adjust the electronic controller, please contact professional service personnel.

STORAGE:

LOAD LINE

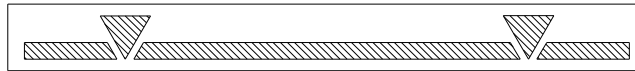

1. The appliance is suitable for storing ice cream.
2. It must not be filled higher than the stacking mark on the inside of the freezer.
3. If there is no load line sticker, please take the top of the placed basket as standard.

DEFROST:

1. Defrost when the frost thickness on the wall of the cabinet reaches 5mm to optimize the freezing capacity.
2. Turn the temperature control to the lowest point for 6 hours before defrosting.
3. Cut off the power and take out the ice cream, use the defrost removal, do not apply sharp tools.
4. After defrosting, clean the wall with a dry cloth, and then power on.

THE FOLLOWING PHENOMENA ARE NORMAL:

1. There will be the sound of flowing water when the refrigerant is running.
2. When the environment humidity is too high, there will be dew condensed on the surface of the freezer.
3. When the appliance is running, the condenser and compressor will be hot.

INSTRUCTION OF THE LOCK:

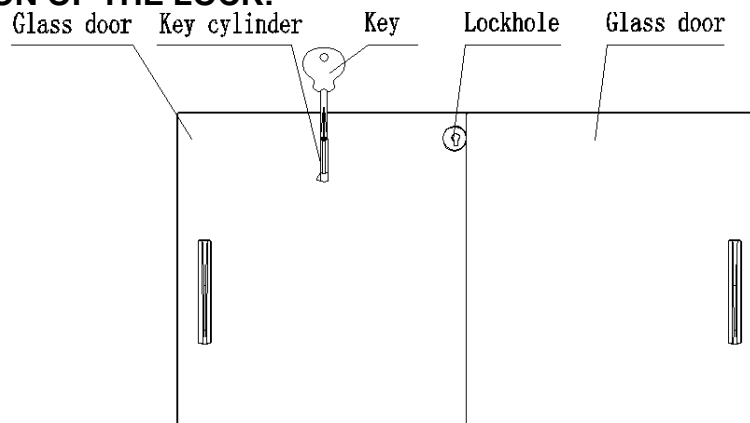

I You can lock the appliance: The first step you put the key and key cylinder into lock hole; The second step you turn the key rotate 90° CW; Then you put out the key.

I You can unlock the appliance: First step you turn the key rotate 90° CCW; The second step you put out the key and key cylinder from lock hole.

REMARK: The lock is one of the options, and your product maybe haven't.

CARE AND MAINTENANCE

MAINTENANCE AND CLEANNESS

Cleaning should be done when needed, to ensure good performance with the minimum amount of energy consumption. If the appliance is used in a dirty environment, it should be cleaned more frequently.

1. Do not open the doors frequently or for too long time to save energy.
2. Never leave heavy or hot stuff on the top of the appliance to avoid deforming.
3. Switch off the appliance and remove the plug from the socket before cleaning.
4. To clean the appliance, please use a soft cloth dampened in some moderate detergent and hot water.
5. Use warm water to clean oil or fruit juice stain on the magnetic gasket in order to keep its elasticity. Apply some talcum powder to it to prolong its service life.
6. If the condenser coil is not cleaned 4 times per year, the efficiency of the appliance will decrease significantly.
7. The appliance should not be left unused for a long time, to stop using the appliance, disconnect the main power first, then clean the inside and leave the doors open for 2-3 days to dry.

STORING THE APPLIANCE AFTER SHUTTING DOWN

NOTICE Unsuitable room temperature during storage can damage your property. Ensure that the room temperature is between -10°C to +50°C . Ensure that the appliance is dry inside and outside.

CORRECT DISPOSAL OF THIS PRODUCT

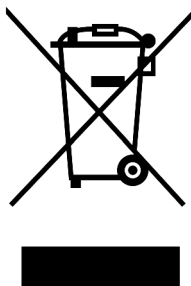

This marking indicates that this product should not be disposed of with other household wastes throughout the EU. To prevent possible harm to the environment or human health from uncontrolled waste disposal, recycle it responsibly to promote the sustainable reuse of material resources. To return your used device, please use the return and collection systems or contact the retailer where the product was purchased. They can take this product for environmentally safe recycling.

REMARK:

The fuse trip current of the appliance is between 10 and 16A.

The A-weighted emission sound pressure level is below 70 dB(A).

TROUBLE SHOOTING

TROUBLES	REASON	SOLUTION
Unfreezing	*Temperature control is on the highest temperature point(1 point)	Adjust temperature control
	*Plug and outlet not connected well	Make both of them connect well
	*Fuse broken off	Change the fuse
Compressor can not stop working	*Temperature control is on the lowest temperature point(7 point)	Adjust temperature control
	*Too much stuff stored in one time	Reduce the quantity
	*Thick frost	Defrost
	*Too many times of door-opening	Reduce the times of door-opening
	*Too near the wall	Far from the wall
	*Near the hot source or sun	Change the place
Too warm	*Temperature control is on the highest temperature point(1 point)	Adjust temperature control
	*Too much stuff stored in one time	Reduce the quantity
	*Too many times of door-opening	Reduce the times of door-opening
	*Near the hot source or sun	Change the place
Too cold	*Temperature control is on the lowest temperature point(7 point)	Adjust temperature control
Big noise or Violent vibration	*Ground is not flat	Change the place
	*Refrigerating tubes connected	Separate them
Water on the floor	*The condensation water on the lids drops down from the drain pipe to the floor	Pour out the water from the water collector
Water condensation on the lids	*The environment humidity is too high	Dry the lids with a soft cloth
Excessive ice formation in cabinet	*Too many times of door-opening	Reduce the times of door-opening
	*The doors are not closed	Close the doors
	*The condensation water on the lids drop inside	Dredge the drainpipe with wire; Defrost
The lighting does not work	*Plug and outlet not connected well	Make both of them connect well
	*The lighting switch is off	Turn on the lighting switch

REMARK: If you can not solve the troubles according to the above-mentioned ways, please contact the after-sale service, do not handle it yourself.

MAINTENANCE OF THE LED LIGHT:

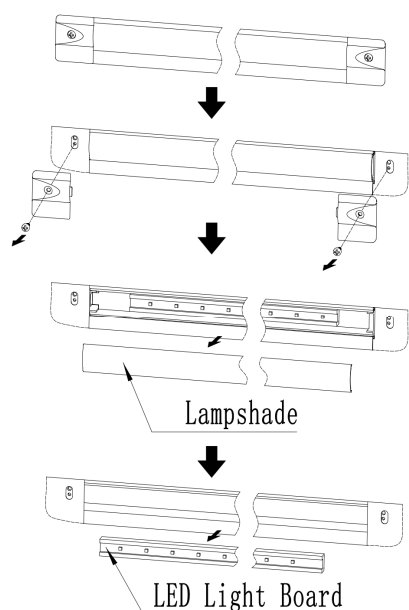

TYPE 1

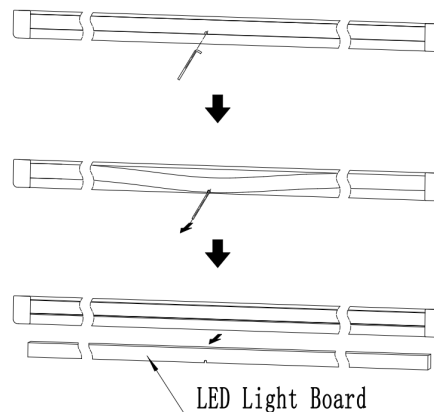

TYPE 2

CAUTION

- I The LED light is one of the options, and your product maybe haven't.
- I If your appliance has an internal LED light and the light is damaged, please contact the after-sale service, do not repair it yourself.
- I This appliance contains a light source of energy efficiency class <G>.

DECLARATION OF CONFORMITY

The appliance complies with the relevant safety regulations and EU Directives 2014/30/EU and 2006/42/EC

ACCESS TO MAINTENANCE INFORMATION:

<http://www.chinahiron.com/>

SPARE PARTS ORDER:

See the importer information post on the back of the appliance.

PRODUCT DATABASE CONNECTION:

Please scan the QR code on the Energy label.

WARRANTY PERIOD:

12 Months

MANUFACTURER NAME:

QINGDAO HIRON COMMERCIAL COLD CHAIN CO.,LTD.

MANUFACTURER ADDRESS:

No.1817,YINZHUSHAN ROAD, HUANGDAO DISTRICT,QINGDAO CITY,SHANDONG PROVINCE, CHINA

MANUFACTURER OFFICIAL WEBSITE:

<http://www.chinahiron.com/>